



Eric Moyle architect, artist and sailor (*Post*, 19 November 1985, p.33)

Eric John Moyle (1924-2001) was born 22 September 1924 at Nurse Stockley's Private Hospital, 590 Newcastle Street, Perth, to Arthur Edwin and Carrie Elma (nee Radford) Moyle of West Leederville. Eric's brother Mervyn Ronald followed in 1926 and sister Lois Ruth in 1928, both born when their parents were resident at Falcon Street in Narrogin. Arthur's work with the railways had taken the family there, but they returned to Perth after a number of years, where the 'abstemious' Carrie enjoyed their living near the Baptist Church in Mount Hawthorn. Eric attended Mount Hawthorn Primary School, and his artistic gifts emerged at an early age.

In 1938 the family moved to Bunbury - Eric left school a year later and worked for a timber company. The job supported him while he went on to complete secondary education at night school within the outbreak of the Second World War (1939-1945). Following the war, Moyle worked for architect Harold Krantz (1906-1999) where he learnt the hard economics of commercial designs; and then also for Marshall Clifton (1903-1975) and Eric Leach (1919-2005). Moyle subsequently passed the Architects Board examinations, registering as an architect in Western Australia (no.201) during March of 1949, before spending a period of time in Melbourne.

Leach had a profound influence on the profession in WA in the post-war period. Interviewed in 1997 on the subject of modern houses in WA, Moyle noted in regard to location and climate that "Eric Leach's background and influence I think was really what he learnt from every day practice and developing an Australian style or a Perth style, ... he wouldn't design a house without decent

sun control.” Effective usage of passive solar design is evident in Eric Moyle’s own housing designs of the austere early 1950s, when building material availability and housing size remained under governmental controls.

In March 1950, local periodical *The Architect* published a manifesto by the twenty-five year old Eric titled ‘Towards a Personal Creed’, which was emblematic of the post-war design orientation in modernism. His concluding words were youthfully aspirational: “Finally, any real architectural wealth that is to be our contribution will be dependent on our careful exhaustive reflection on every single factor relative to the particular problem and the intuitive, imaginative unity that we compose from those elements.”

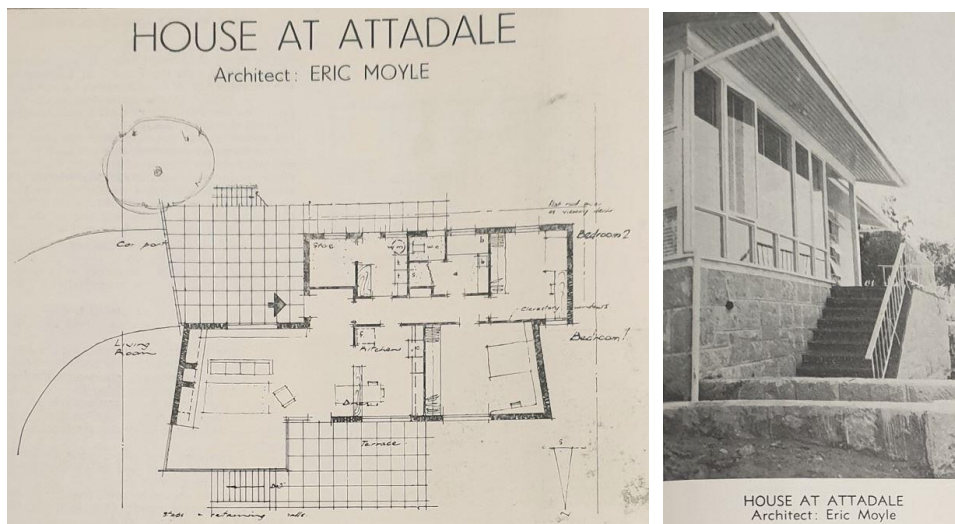

Residence at Attadale of 1952 (*The Architect*, December 1952, p.18)

In the late 1940s Eric Leach designed a home for his family on a site at Saunders Street, Mosman Park, and this project was stimulating for Eric Moyle’s developing professional career. In June 1954, the *Sunday Times* correspondent noted one of Moyle’s residential designs located adjacent to the influential Leach residence:

During the last two years seven homes to a total value of £70,000 have been built or are under construction in Saunders-street Mosman Park – often designated the Mon Repos area. From them can be gained unexcelled views of the river across Mosman Bay to Perth and the Darling Ranges to the east. One of those under construction is the home of Dr. and Mrs. V.A. Read. A two-level house it has been designed by the architect Mr Eric Moyle to conform with the contours of the site.

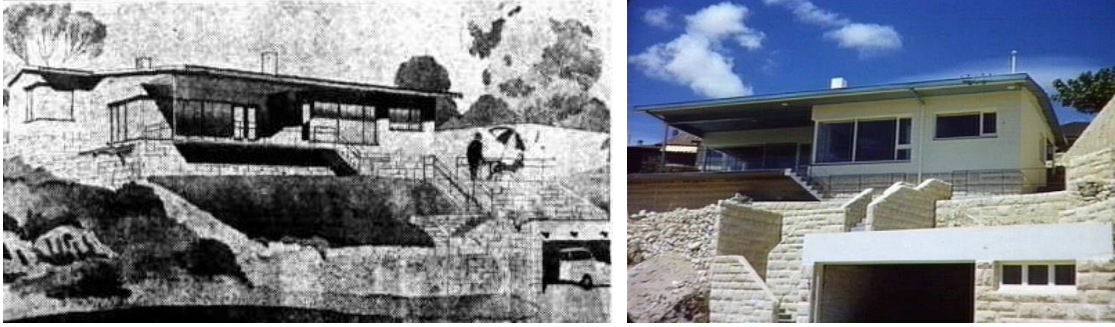

Eric Moyle's drawing of Read house at Saunders Street Mosman Park (*The West Australian*, 19 June 1954, p.16); mid-1950s colour photo (State Library of Victoria, a22438)

Architect Eric Moyle of Mt Hawthorn and nurse Eileen Jenkin of Nedlands were married at St Andrew's Church, East Claremont in October 1953. In 1956 Eric designed a new residence with a 'batwing' roof on a steeply sloping site at 48 Devon Road Swanbourne. The house was to accommodate the growing Moyle family, including son Radford and daughter Rikili, and it was angled both to give the most favourable solar orientation and to benefit from the panoramic views over Lake Claremont. The pragmatic architect remarked to a journalist of the unusual roof form: "It came about simply in an effort to solve a particular problem of orientation and contouring on a certain site".

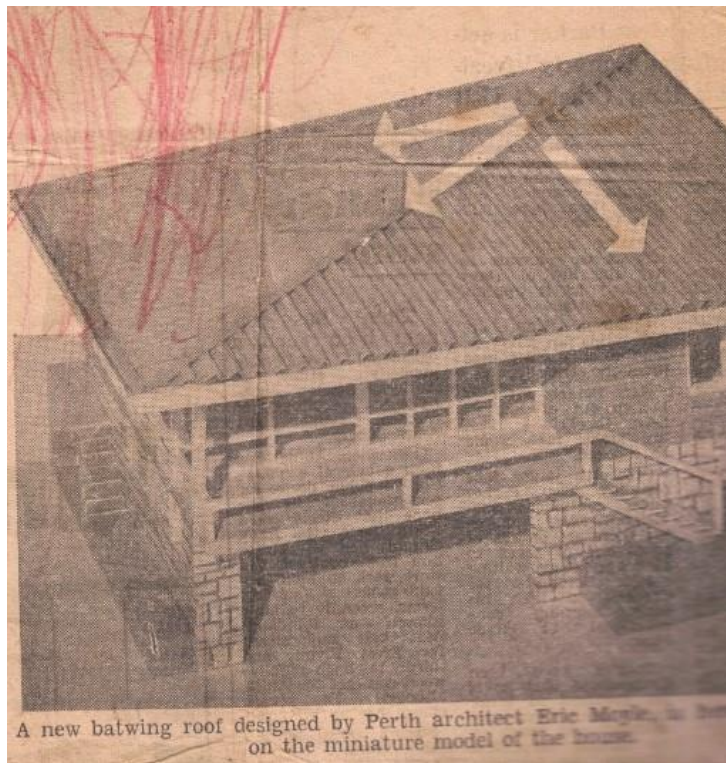

Moyle residence at 48 Devon Road Swanbourne of 1956: the house is extant but the property has been subdivided (Jane Scott, 'A new batwing roof by Perth architect', *Sunday Times*, n.d.)

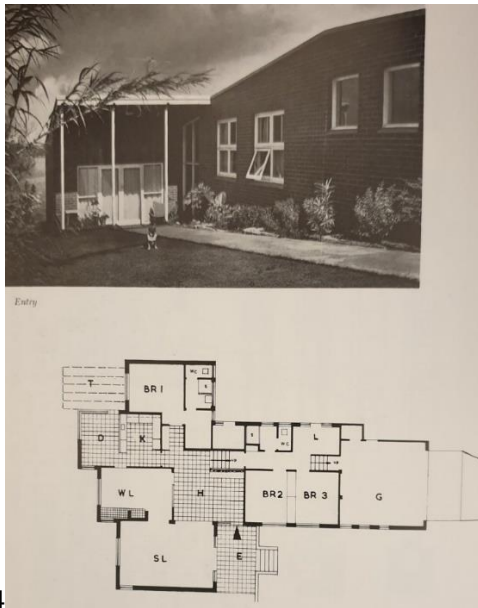

4

The Stott Residence at 112a Victoria Avenue Dalkeith, designed by architect Eric Moyle in 1961 (*Modern Houses*, p.74 - from *The Architect*, Dec 1962); the interior in 1962 (SLWA 340565PD)

Interviewed in 1997 on the influence of modern houses in WA and noting his thoughts on 1960s works, Eric mentioned the innovative designs of Peter Overman (1931-2000) and also stated that: "The most significant group that formed public opinion would have been the winning design for the Empire Games Village [Commonwealth Games at Perth 1962]. Now they were definitely breaking into a good standard of design and I'm sure that the people who bought these houses eventually appreciated the designs ... It also coincided with the growth of people like Corser Homes and that was a firm that I worked for for some years, and again there was discipline imposed of getting the best value out of the plan ... Syd Corser was a very important factor in post-war design ...".

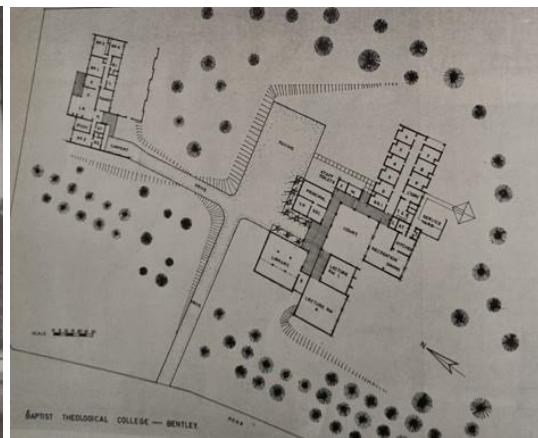

Baptist Theological College by McCardell, Moyle & Barrett (*The Architect*, 9 1 1968, pp.50-53)

Eric worked in partnership with Fred McCardell (1906-2007) and Ken Barrett (1939-2012) for a period during the late 1960s. In 1969 the Moyles travelled to live for a few months in England and Greece. Based in Stroud, near Gloucester, Eric enjoyed the chance to extend his professional experience and to appreciate the world beyond Australia. The fabulous Greek island scenery emerged in his artwork following this sojourn.

Recognising his professional achievements, Eric was elected a Fellow of the Royal Australian Institute of Architects (RAIA) in 1970. Eric's family note that architecture, painting, and sailing were his great joys – with Radford and Rikili enjoying summers at the Cockburn Regatta and within the bays of Rottnest Island. Amongst his sailing successes, Eric won the Fremantle to Koombana Bay race in 1970, and the Cape Naturaliste and return race with his half-ton yacht *Bouboulina*, a Spirit 28.

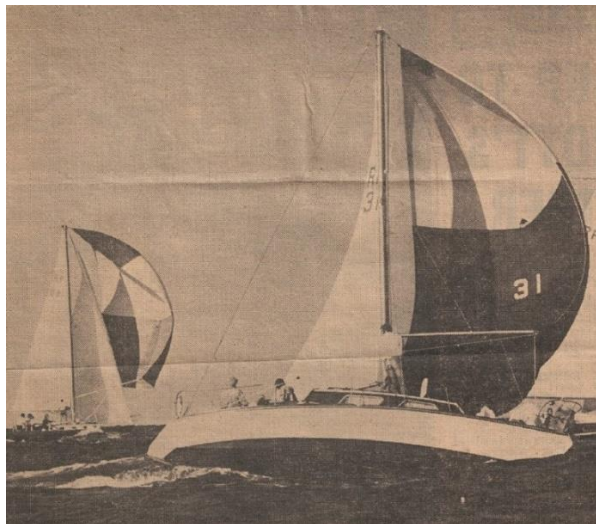

Eric Moyle sailing *Outlaw* (RF31) in the Fremantle to Bunbury and return race during the 1970s, soon after the start at the North Mole - *Hotspur* (P. Packer) at left and *Hazard* (M. Finn) at right (newspaper clipping n.d. courtesy Radford Moyle)

State Records Office files record a significant quantity of State Government works by Moyle & Barrett in the 1970s, including schools, Dental Health Services and Agricultural Department projects. Eric's son Radford recalls that: *Dad did have a long association with the Baptist Church and also the Anglican church. They did quite a few jobs for them including the Dorothy Genders Village in Mosman Park. They also had a long association with the Canning Vale Fruit & Veg Markets which they did also. They designed office buildings, 918 Canning Highway Applecross, 51 & 53 Colin St West Perth.*

In 1975 the Institute of Arbitrators Australia was established. Among the foundation members were a number of architects who were prominent in RAI A affairs including Eric Moyle, David Kelsall, Anthony de Leo, Frederick McCardell, John Pidgeon and David Standen. It appears that Eric Moyle retired from practice in the 1980s.

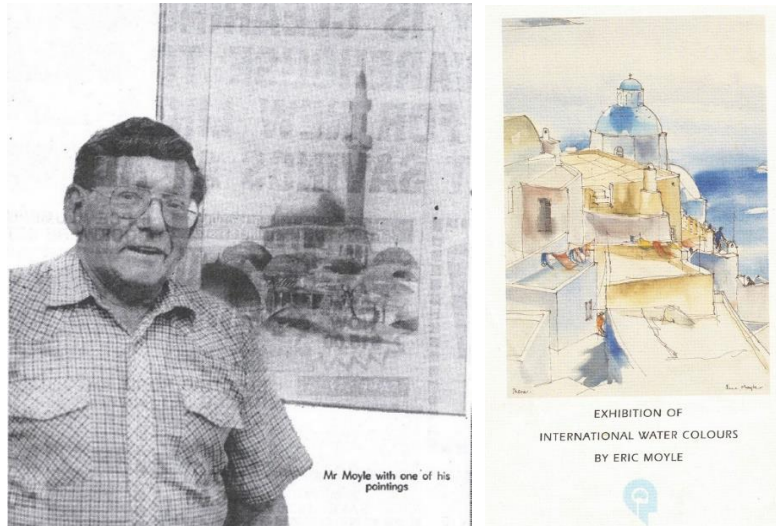

Eric at his 1985 art exhibition, Claremont Railway Station (West Advertiser 27 February 1985);
Cover for an art exhibition of 19 April 1993 (Radford Moyle)



Eric Moyle in later years (photo by Geoff Fisher, *The West Australian*, 24 January 2002, p.51).

Eric Moyle died 31 December 2001 at Cottesloe, aged 77 years. He was survived by his brother Mervyn and his sister Lois Horne, son Radford and daughter Rikili Vitko, second wife Lerrida, stepson Peter, and five grandchildren.

References:

- 'Births', *The West Australian*, 24 September 1924, p.1 (birth of Eric).
- Eric Moyle, 'Towards a Personal Creed', *The Architect*, March 1950, p.11.
- 'Tenders', *The West Australian*, 23 May 1953, p.20 (brick and tile residence cnr Brighton and North Streets Cottesloe).
- 'Approaching Marriage', *The West Australian*, 9 October 1953, p.17 (at St Andrew's Church).
- 'New Homes at Mon Repos', *The West Australian*, 19 June 1954, p.16 (Dr V.A. Read house Saunders Street Mosman Park).
- 'Tenders', *The West Australian*, 31 July 1954, p.28 (kiosk at The Esplanade Scarborough).
- 'This Mt Yokine home has luxury look at low cost', *Sunday Times*, 17 April 1955, p.34 (Blythe Avenue Yokine house critique by Jane Scott/Ray Oldham).
- 'Sheltered terrace formed by L-plan', *Sunday Times*, 11 December 1955, p.34 (Brighton Road Scarborough house critique by Jane Scott/Ray Oldham).
- 'Planned for future extensions', *Sunday Times*, 29 January 1956, p.30 (Brighton Road Scarborough house critique by Jane Scott/Ray Oldham).
- Baptist Theological College by McCardell, Moyle & Barrett, *The Architect* 9 1 1968, pp.50-53.
- SROWA: Item 1968/0127 - Eric Moyle architect: correspondence; and works by Moyle & Barrett
- Item 1970/0598 - Cloverdale (Fisher Street) Primary School - Additions 1970/71
- Item 1970/0709 - Whiteside Primary School - Whiteside Street, Cloverdale - Additions 1970/71
- Item 1971/0946 - Collie High School - Additions – Canteen
- Item 1972/0429 - Mukinbudin Jnr High School Manual Arts, Home Science and Science Rooms
- Item 1972/0442 - Broome Junior High School - Manual Arts, Home Science & Science Rooms
- Item 1973/0432 - Mirrabooka High School - Additions 1973/74 - Staff Room & Toilets
- Item 1973/0478 - Whiteside Primary School - Additions 1973/74 - Library, Resource
- Item 1974/0616 - Craigie Primary School - 6 Classrooms & Covered Assembly
- Item 1974/0845 - Public Health Department - School of Dental Therapy Warwick
- Item 1974/0985 - Mirrabooka Senior High School - Hall/Gymnasium
- Item 1974/1755 - Agricultural Department - South Perth - Provision of Dairy Building Plans
- Item 1974/1890 - Mirrabooka Senior High School – Library
- Item 1974/1938 - Craigie Primary School - 6 Classrooms & Resource Centre.
- 'Interview with Eric Moyle, Architect', 19 April 1993 (courtesy Radford Moyle).
- London, Geoffrey and Richards, Duncan; *Modern Houses: Architect-designed Houses in Western Australia from 1950 to 1965*, School of Architecture, UWA, 1997, pp.26, 29, 31-36, 74.
- Richards, Duncan, *High Hopes - A history of the Institutes of Architecture in Western Australia*. Royal Australian Institute of Architects (WA), 2003, pp.114, 159.
- 'Vistas and Visions', *The West Australian*, 24 January 2002, p.51 (obituary by Patrick Cornish).
- Pers. comm. Radford Moyle, 20 January 2021, 9 February 2022.

Contributing author: John Taylor

Heritage Committee meeting approval date: 21 April 2022 Last updated: 13 May 2022

Citation details:

Taylor, Dr John J., 'Eric John Moyle (1924-2001)', Western Australian Architect Biographies, <http://www.taylorarchitects.com.au/Biographies.html> accessed DATE.